

## QUASAR



24 Vdc | 120 - 230 Vac

Chain actuator  
Force in push action 300 N  
Maximum stroke 500 mm



### High performance in small die-cast aluminum casing (47 x 32 mm).

- › Chain in double stainless-steel links, exit in central position.
- › Electronic stop in the intermediate positions in case of overload.
- › The stop in closing position is regulated by an electronic limit switch control.
- › Quick and easy installation: the manual closing position regulation is not required.
- › Suitable for combined installation with the additional locking device E-LOCK and PLUSULTRA.
- › QUASAR versions with IP42 protection class, for a higher resistance against atmospheric agents, available upon request.

- ›  and  versions for USA and Canada.
- › 24 Vdc version is suitable for installation on Smoke and Heat Exhaust Ventilators (SHEV) in conformity to European Standard EN 12101-2, tested by Istituto Giordano.

For installation remarks refer to the section at page 33 or contact UCS's technical department for further information.



POSSIBLE APPLICATIONS

OUTWARD OPENING

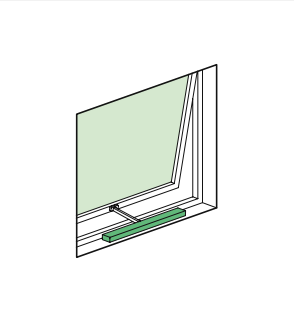

Top hung window.

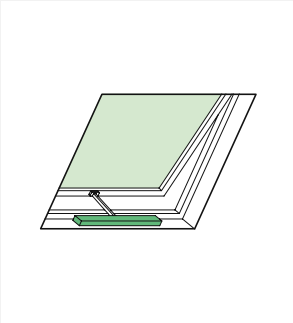

Top hung roof window.

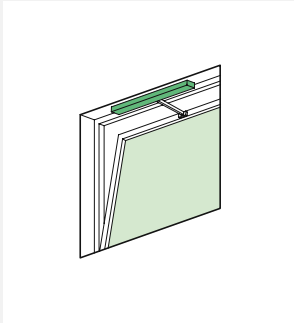

Bottom hung window.

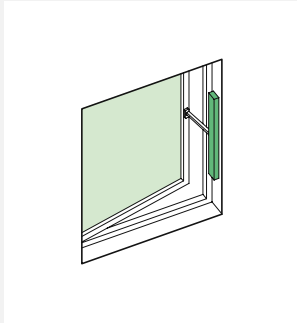

Side hung window.

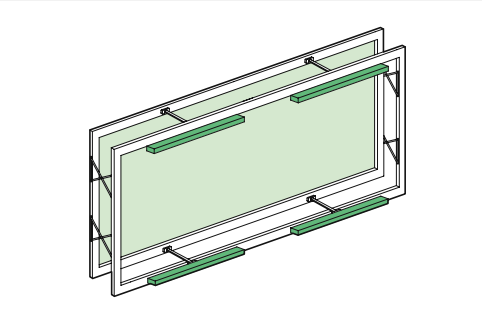

Parallel window.

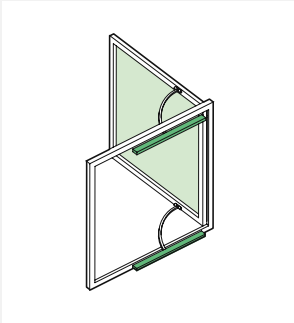

**BOW CHAIN.** Side hung window.

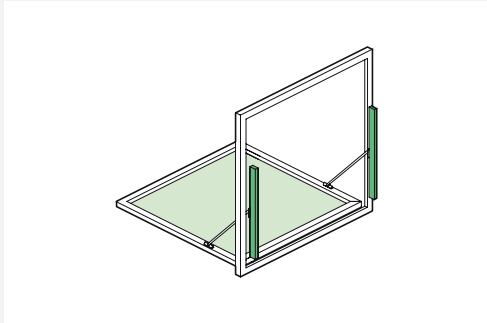

**DRAW BRIDGE.** Bottom hung window.

INWARD OPENING

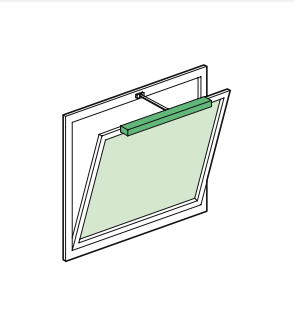

Bottom hung window.

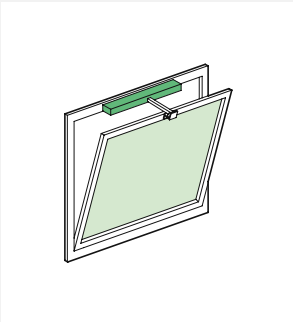

Bottom hung window.

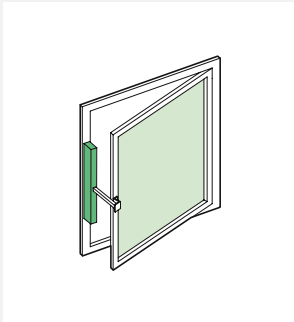

Side hung window.

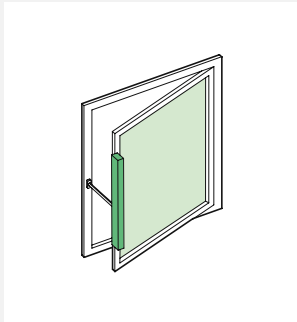

Side hung window.

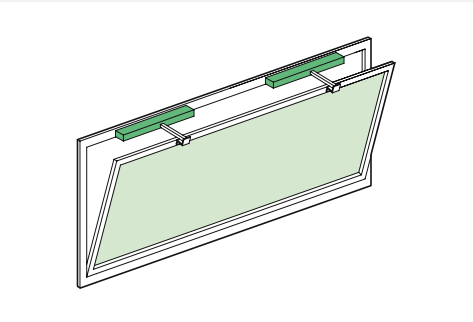

Bottom hung window.

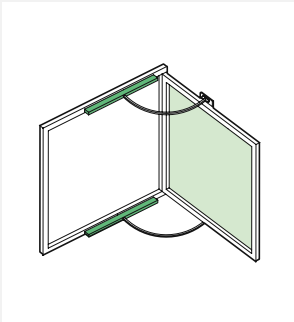

**BOW CHAIN.** Side hung window.

LEGEND

- Common application
- Special application

SPECIAL VERSIONS



QUASAR BOW CHAIN

UP TO 90 DEGREES OPENING thanks to a bow chain, allowing a wide opening angle according to the window size.

The need to increase the opening angle of many currently manufactured vents is becoming very important to increase the flow of fresh air for natural ventilation and smoke and heat extraction for life safety.

- Bow chain in double stainless-steel links available up to 500mm.
- Suitable for side hung windows opening inwards or outwards, increasing the opening angle up to 90°.
- The distance of the chain exit from the pivoting hinges must be 340 mm.
- Suitable for installation with the additional locking device E-LOCK, granting a perfect tightness of the windows, even on very high sashes.
- QUASAR BOW CHAIN is available in Synchro version; DC, and BMSline versions upon request.
- Brackets can be customized according to the aluminum profile system.

QUASAR DRAW BRIDGE

Especially for smoke ventilation, wide opening angle represents a big advantage in order to reduce the number of openable windows, according to the required efficiency or geometrical free area. QUASAR DRAW BRIDGE is equipped with a special guide for the chain and can increase the opening angle up to 90°, taking in consideration the window size and weight.

- QUASAR DRAW BRIDGE in double stainless-steel links available up to 500mm.
- QUASAR DRAW BRIDGE can be installed in DRAW BRIDGE configuration on bottom hung windows opening inwards or outwards.
- Suitable for installation with the additional locking device E-LOCK, granting a perfect tightness of the windows, even on very high sashes.
- QUASAR DRAW BRIDGE is available in Synchro version; DC, and BMSline versions upon request
- Brackets can be customized according to the aluminum profile system.

Contact our Technical Department for the installation limits (size and weight of window) and brackets for actuator installation (depending on type of profile).



TECHNICAL DATA

VERSION	AC VERSION	DC VERSION	BMSline VERSION
VOLTAGE SUPPLY	120 - 230 Vac	24 Vdc ± 10%	24 Vdc ± 10%
CURRENT ABSORPTION (max load)	0,4 A - 0,2 A	0,9 A	0,9 A
OPERATION	OP / COM / CL	polarity inversion	programmable
MAX FORCE (see force/stroke diagram)	300 N	300 N	programmable up to 300 N
OPENING SPEED	≈ 15 mm/s	≈ 15 mm/s	programmable up to 15 mm/s
CLOSING SPEED	≈ 15 mm/s	≈ 15 mm/s	programmable up to 15 mm/s
LOCKING FORCE	3000 N*	3000 N*	3000 N*
DUTY CYCLE	50%	50%	50%
PARALLEL CONNECTION	Yes	Yes	Yes
LIMIT STOP	Electronic	Electronic	Electronic
SAFETY STOP	Electronic	Electronic	Electronic
PROTECTION CLASS	IP40**	IP40**	IP40**

\* Installation without pivoting brackets.  
\*\* Version with IP42 protection class available upon request.

DIMENSIONS

Chain connector included.

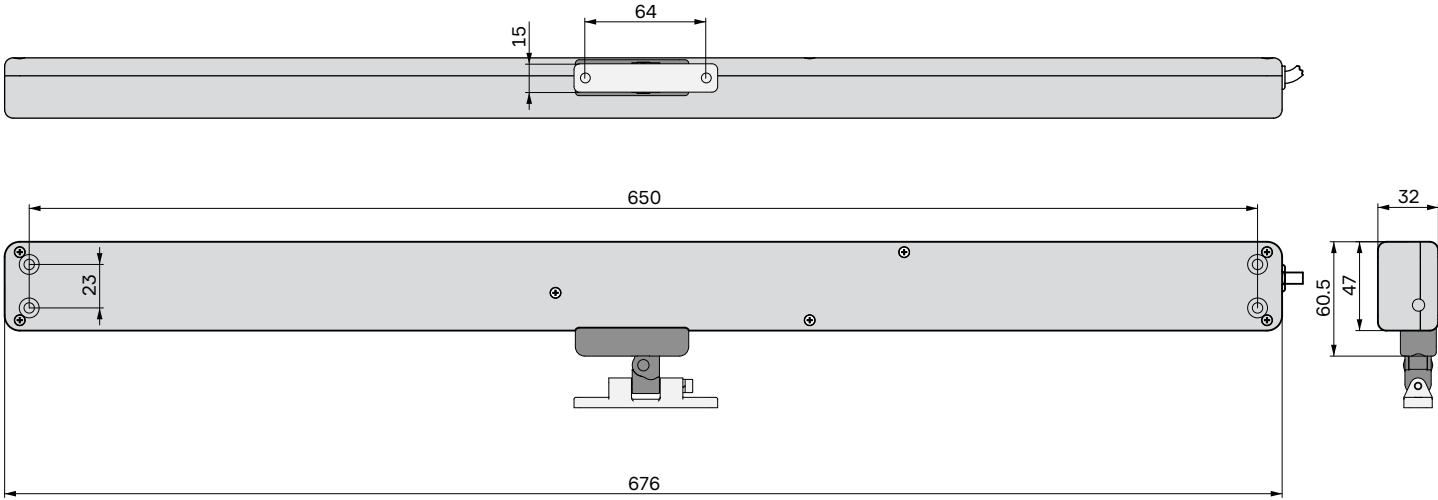

SYNCHRO

The QUASAR SYNCHRO versions are equipped with an integrated speed synchronization control board for the installation of more than one actuator on the same vent, avoiding any external control panel (max 4 actuators + E-Lock).  
Available also in AC version: 1 QUASAR SYNCHRO AC + 1 QUASAR SYNCHRO DC (max 2 couples).



F-SIGNAL

The QUASAR F-SIGNAL versions provide free potential opening and closing feedback signal (maintained contact), activated by the current limit.  
The free potential feedback is often required to share with third part devices the status of the windows.



BMSline

The QUASAR BMSline version is fully programmable (stroke length, speed, force, ...) and addressable via the dedicated Modbus RTU communication line for the integration in the Building Management System. Introducing special features like: real-time feedback, entrapment risk reduction, statistics, override of local push button by BMS, quite operation for Natural Ventilation and full speed for Smoke Ventilation.  
For complete feature description refer to the BMSline section at page 20.

PART No.

AC POWER SUPPLY (100 - 240 Vac)

MODEL	SYNCHRO	FEEDBACK	CABLE	STROKE	→ COLOUR / ↓ PART No.		
					GREY RAL 9006	BLACK RAL 9005	WHITE RAL 9010
QUASAR AC	-	-	1,5 m 3 wires + earth	500 mm	40837Z	40838A	40839B
QUASAR AC SYNCHRO	Yes	-	2 x 3 m cables: › 3 wires + earth › 5 wires	500 mm	41316I	41317J	41318K

DC POWER SUPPLY (24 Vdc)

MODEL	SYNCHRO	FEEDBACK	CABLE & BUS LINE	STROKE	→ COLOUR / ↓ PART No.		
					GREY RAL 9006	BLACK RAL 9005	WHITE RAL 9010
QUASAR DC	-	-	1,5 m 2 wires	500 mm	40840C	40841D	40842E
QUASAR DC SYNCHRO	Yes	-	3 m 5 wires	500 mm	41119Z	41120A	41121B
QUASAR DC F-SIGNAL	-	Free potential Open/closed	1,5 m 5 wires	500 mm	41327T	41328U	41329V
QUASAR DC SYNCHRO F-SIGNAL	Yes	Free potential Open/closed	2x3m cables: › 5 wires › 3 wires	500 mm	41319L	41320M	41321N
QUASAR DC SYNCHRO BOW CHAIN	Yes	-	3 m 5 wires	510 mm	48081B	48063L	48074W
QUASAR DC SYNCHRO DRAW BRIDGE	Yes	-	3 m 5 wires	500 mm	41928J	41929K	41930L
QUASAR BMSline	Yes	All features via BUS line	Supplied with 2x3 m cables: › 2 wires voltage supply › 2 wires Synchro/E-Lock › 3 wires local switch › 3 wires Modbus RTU › 2 wires smoke ventilation	500 mm	48035J	48036K	48037L

POSSIBLE APPLICATIONS & ACCESSORIES

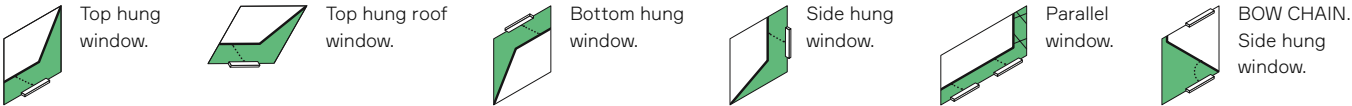

OUTWARD OPENING

INSTALLATION EXAMPLE 01

Front installation with long slim bracket kit.

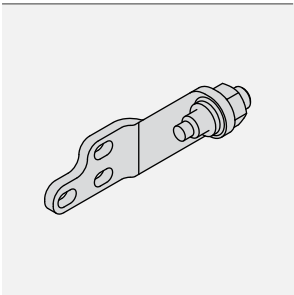
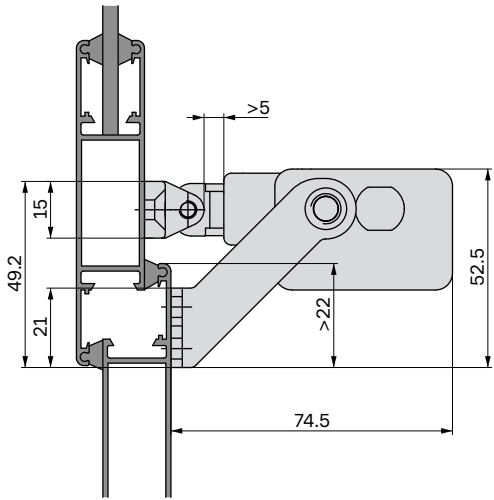

Long slim bracket kit

GREY RAL 9006	41898F
BLACK RAL 9005	41899G
WHITE RAL 9010	41900H

INSTALLATION EXAMPLE 04

Concealed vent with short slim bracket kit.

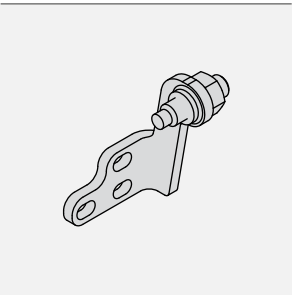
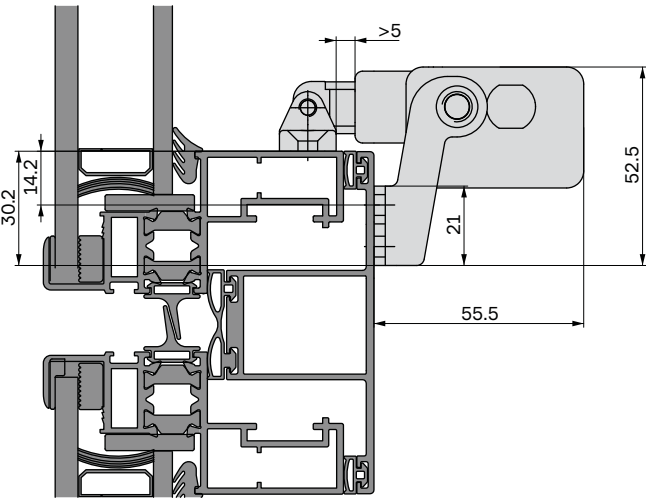

Short slim bracket kit

GREY RAL 9006	41901I
BLACK RAL 9005	41902J
WHITE RAL 9010	41903K

INSTALLATION EXAMPLE 02

With die-cast bracket kit.

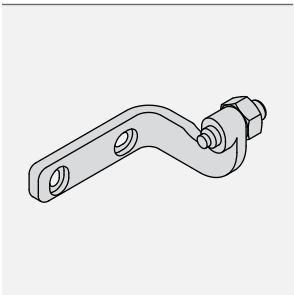
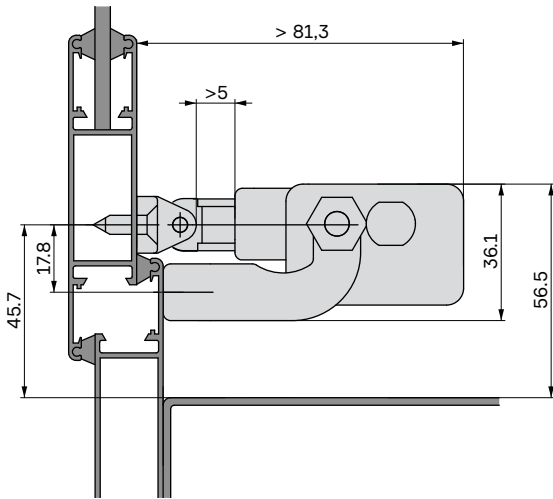

Die-cast bracket kit

GREY RAL 9006	40843F
BLACK RAL 9005	40844G
WHITE RAL 9010	40845H

INSTALLATION EXAMPLE 05

Concealed vent with long bracket kit.

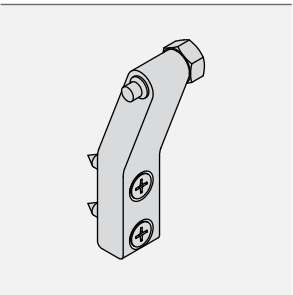
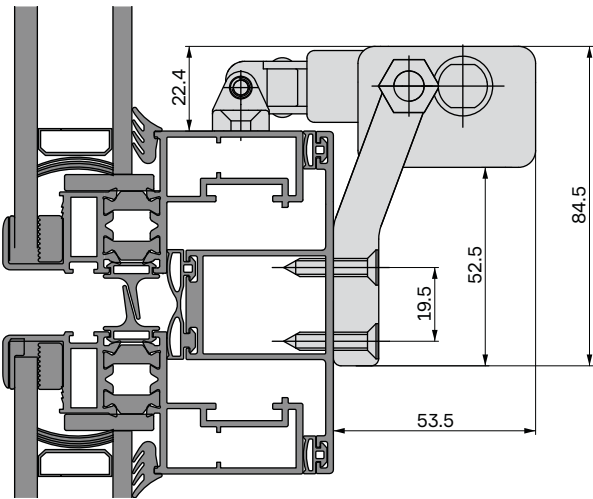

Long bracket kit

GREY RAL 9006	40941H
BLACK RAL 9005	40942I
WHITE RAL 9010	40943J

INSTALLATION EXAMPLE 03

With windowsill with die-cast bracket.

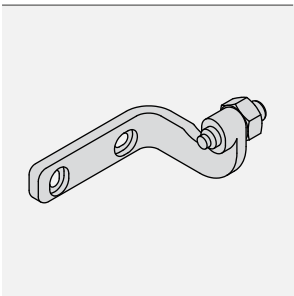
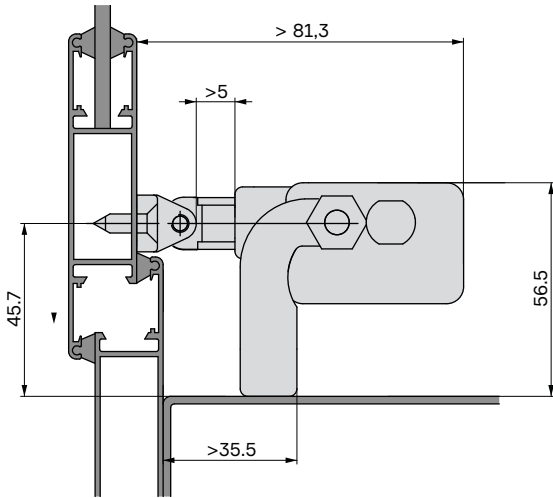

Die-cast bracket kit

GREY RAL 9006	40843F
BLACK RAL 9005	40844G
WHITE RAL 9010	40845H

POSSIBLE APPLICATIONS & ACCESSORIES

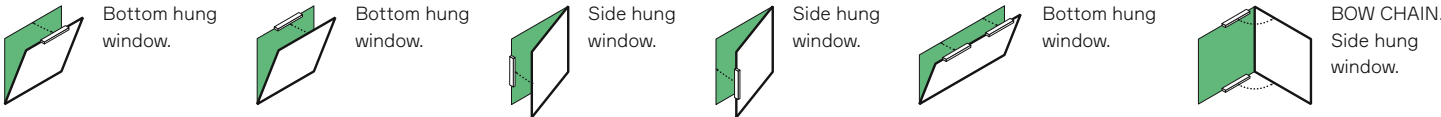

INWARD OPENING

INSTALLATION EXAMPLE 01

On the frame with adjustable Z bracket.

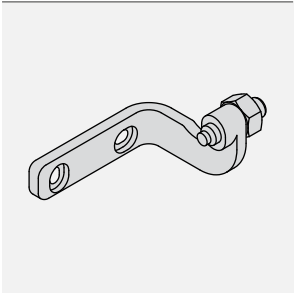
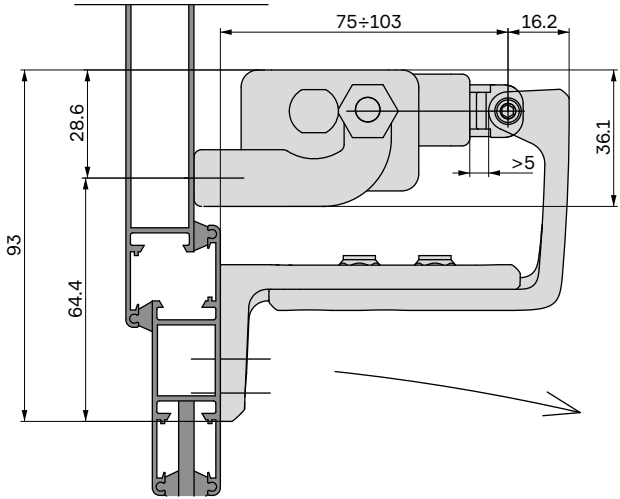

Die-cast bracket kit

GREY RAL 9006	40843F
BLACK RAL 9005	40844G
WHITE RAL 9010	40845H

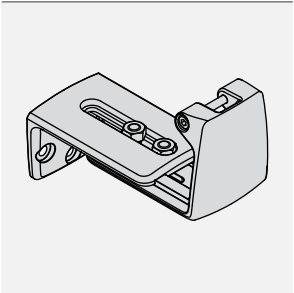

Adjustable Z bracket kit

GREY RAL 9006	41709Z
BLACK RAL 9005	41710A
WHITE RAL 9010	41711B

INSTALLATION EXAMPLE 02

On the vent with long braket kit.

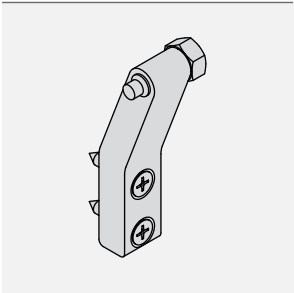
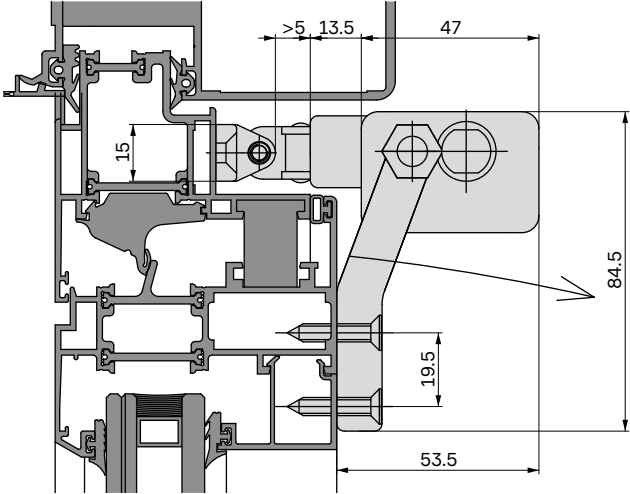

Long bracket kit

GREY RAL 9006	40941H
BLACK RAL 9005	40942I
WHITE RAL 9010	40943J

